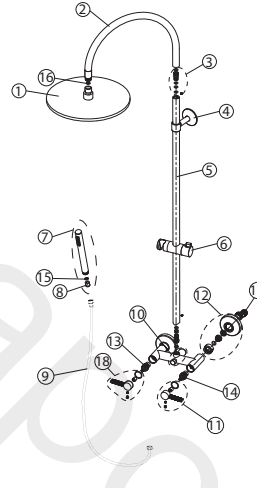

100304093 brushed gold

LUXE. Shower column with mixer taps, L1249MM. Upper circular curve shower bar, D300MM shower head, round hand shower including check valve, sliding hand shower holder. With connections of 1/2 "and with a distance of 150±20mm between them. The flow rate at 3 bar is 6,3 l/min of the hand shower and 10,9 l/min of the shower head .

**Spare parts**

POS.	SAP	ART.	RRP*
1	100304843	LIGN.SHO.COL -BRUSH GOLD SHO.HEAD	-
2	100304847	LIGN.SHO.COL -BRUSH GOLD UPPER CURVE	-
3	100277983	LIGN.SHO.COL -TUBES CONNECTOR	-
4	100304854	LIGN.SHO.COL -BRUSH GOLD WALL BRACKET	-
5	100304840	LIGN.SHO.COL -BRUSH GOLD STRAIGHT TUBE	-
6	100304829	LIGN.SHO.COL -BRUSH GOLD SLIDER HOLDER	-
7	100304850	LIGN.SHO.COL -BRUSH GOLD HAND SHOWER	-
8	100281015	LIGN.SHO.COL -HAND SHOW.CHECK VALV	-
9	100304855	LIGN.SHO.COL -BRUSH GOLD FLEXIB.HOSE	-
10	100304853	LIGN.SHO.COL -BRUSH GOLD DIVERTER	-
11	100304862	LIGN.SHO.COL -BRUSH GOLD LUX COLD HAND	-
12	100304848	LIGN.SHO.COL -BRUSH GOLD WATER.IN+TRIM	-
13	100281053	LIGN.SHO.COL -BRUSH GOLD COLD CARTRIDG	-
14	100281001	LIGN.SHO.COL -BRUSH GOLD HOT CARTRIDG	-
15	100268622	1/2 "GASKET WITH MESH FILTER	-
16	100304861	LIGN.SHO.COL -BRUSH GOLD ECCENTRIC KIT	-
17	100304863	LIGN.SHO.COL -BRUSH GOLD LUX HOT HAND	-