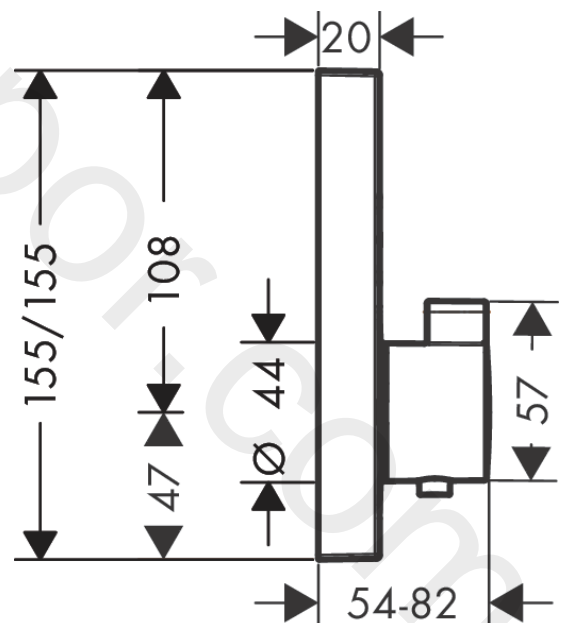

ShowerSelect**Thermostat for concealed installation for 2 functions**Finish: **Polished Gold Optic** Article Number: **15763997****Description****product features**

- 2 functions
- simultaneous use of several outlets
- Select push-button on/off control for 2 outlets
- thermostat cartridge, Start/stop valve to operate the functions
- maximum flow rate at 3 bar: 29,7 l/min
- flow rate upper outlet: 25 l/min
- flow rate lower outlet: 23 l/min
- flow rate by simultaneous use of all outlets: 29,7 l/min
- min. operating pressure: 1 bar
- max. operating pressure: 10 bar
- Safety stop at 40 °C
- temperature limitation adjustable
- connection type: basic set
- thermostat is delivered with buttons hand shower and Rain large

Technology**Product image****Scale drawing**

ShowerSelect

Thermostat for concealed installation for 2 functions

Finish: **Polished Gold Optic** Article Number: **15763997**



Flowchart

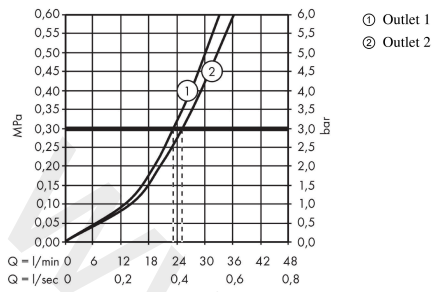

ShowerSelect

Thermostat for concealed installation for 2 functions

Finish: **Polished Gold Optic** Article Number: **15763997**



Exploded Drawing

Year of production: >03/20

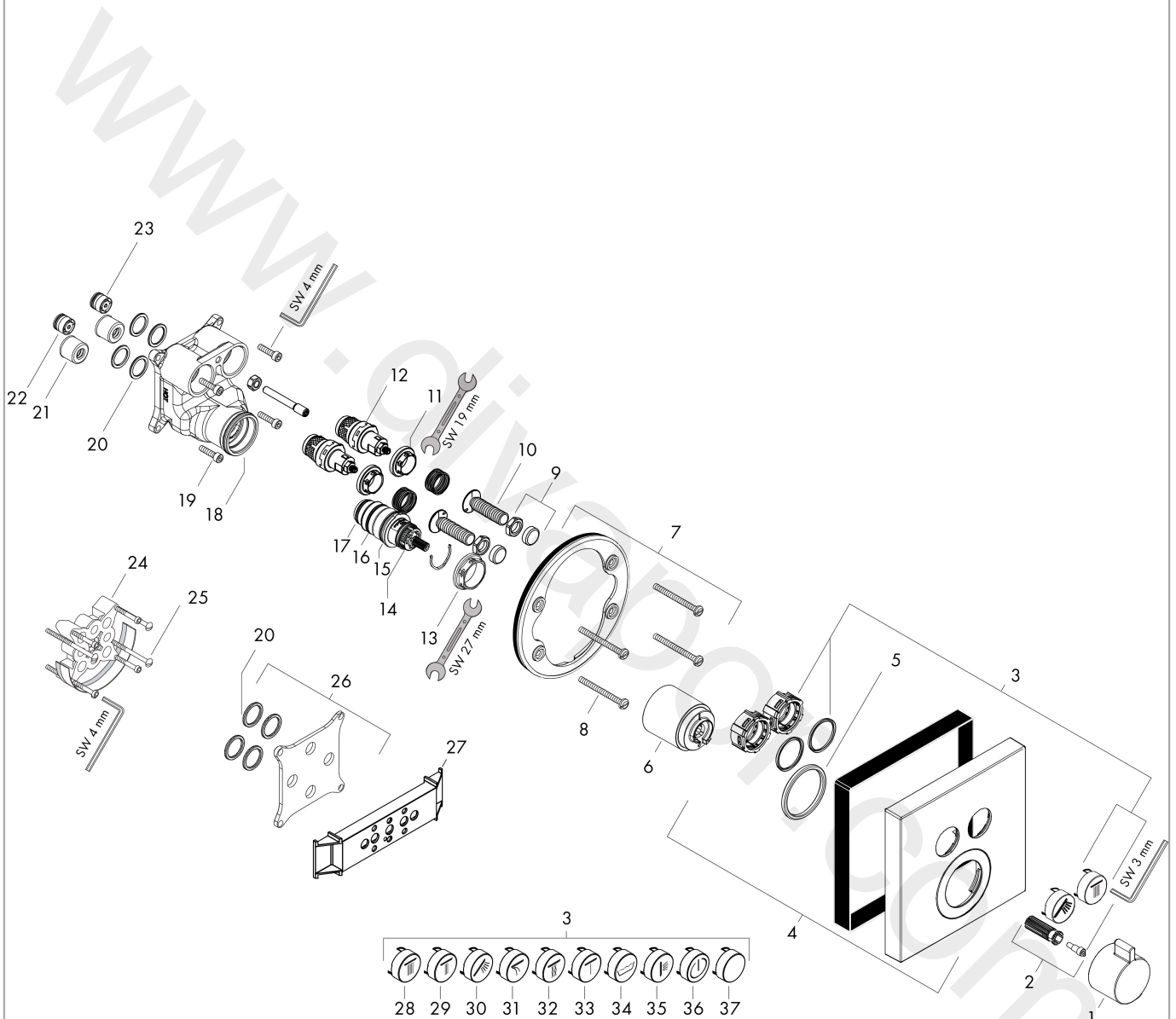

ShowerSelect

Thermostat for concealed installation for 2 functions

Finish: Polished Gold Optic Article Number: 15763997



Spare part list

Year of production: >03/20

Pos.	Description	Article Number	Price	PU
1	handle for thermostat	92215990	£ 96,00	1
2	handle fixing set	95843000	£ 9,00	1
3	set of symbols	92218000	£ 79,00	1
4	escutcheon 155 / 155 mm	92217990	£ 163,00	1
5	O-ring 44x4	98471000	£ 9,00	1
6	sleeve	92216990	£ 51,00	1
7	holder for escutcheon	98793000	£ 43,00	1
8	set of fixing screws	96454000	£ 9,00	1
9	nut and flange	92696000	£ 16,10	1
10	Select-adapter	92219000	£ 6,10	1
11	nut	98368000	£ 13,30	1
12	shut off unit	95758000	£ 110,00	1
13	nut	98913000	£ 20,50	1
14	thermostat cartridge	98282000	£ 110,00	1
15	O-ring 20x1,5	98197000	£ 3,30	1
16	O-ring 25x1,5	98146000	£ 3,30	1
17	O-ring 25x2,5	92146000	£ 9,00	1
18	O-ring 36x2	98156000	£ 3,30	1
19	set of screws	96525000	£ 9,00	1
20	O-ring 16x2	98133000	£ 3,30	1
21	noise reduction	94073000	£ 25,00	1
22	non return valve (pressure-resistant up to 2 MPa)	92594000	£ 16,10	1
23	non return valve	97980000	£ 16,10	1
24	extension 25 mm	13595000	£ 75,00	1
25	set of fixing screws	97747000	£ 3,30	1
26	compensation set 1°	95521000	£ 173,00	1
27	fit-up aid	92540000	£ 14,10	1
28	symbol head shower Rain large	93571880	£ 9,00	1
29	symbol head shower Rain small	93572880	£ 9,00	1
30	symbol handshower	93573880	£ 9,00	1
31	symbol Flood jet	93574880	£ 9,00	1
32	symbol Whirl	93575880	£ 9,00	1
33	symbol Mono	93576880	£ 9,00	1
34	symbol tub	93577880	£ 9,00	1
35	symbol body shower	93578880	£ 9,00	1
36	symbol ON/OFF	93579880	£ 9,00	1
37	pushbutton	93955880	£ 20,50	1
a	-	01800187	-	1
b	cartridge for exchanged connections	92373000	£ 275,00	1
c	extension 22 mm	13593000	£ 79,00	1
d	Grease	90920000	£ 16,10	1