

170099 - Kisdon Mono mixer

Useful Information	
Minimum operating pressure	0.5 bar
Maximum operating pressure	5 bar
Wickes Guarantee	5 years

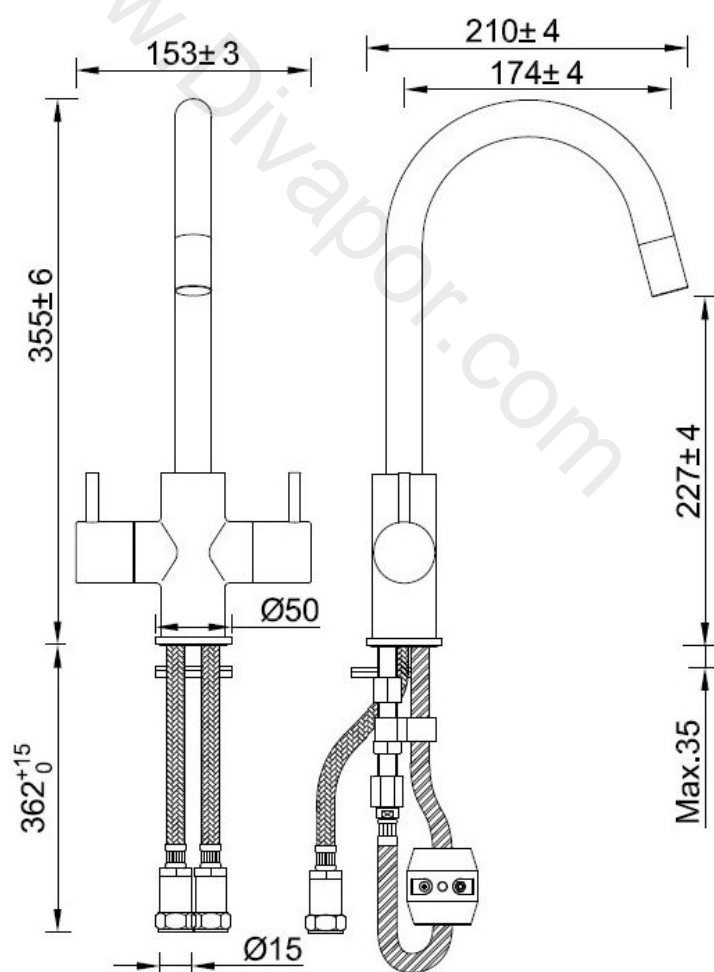

Technical Diagram



Exploded Diagram

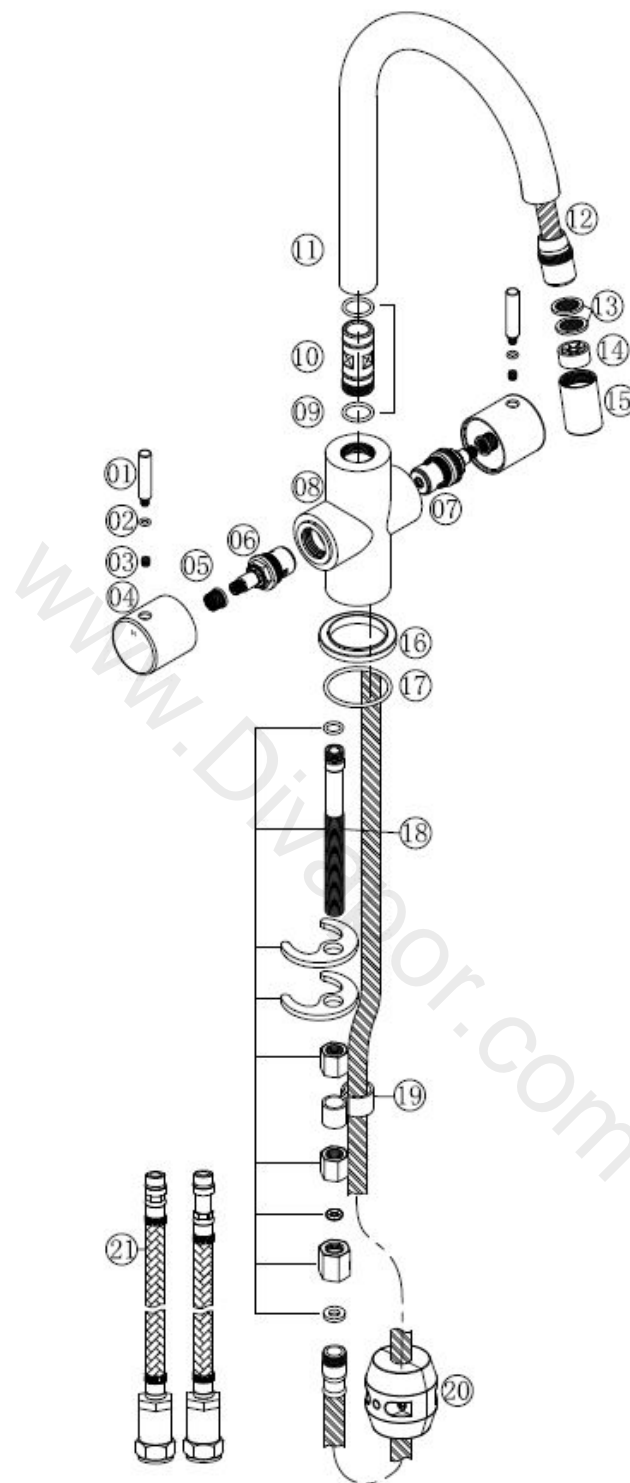

Item Number	Supplier Ref	Description	Quantity	Material	Spares Available
1	907016-H-G	Handle Lever	2	BRASS	Yes
2	OR052	O Ring	2	EPDM	Yes
3	SC5-5SN	Screw	2	Stainless Steel	Yes

4	907016-H-Z	Handle Seat	2	ZINC	Yes
5	SA03	Spline Adaptor	2	POM	Yes
6	VS01-C20	1/2" CD Valve	1	BRASS+EPDM+Ceramic Disc	Yes
7	VS01-C20	1/2" CD Valve	1	BRASS+EPDM+Ceramic Disc	Yes
8	907015Z-01	Tap Body	1	BRASS	No
9	OR056	O Ring	2	EPDM	No
10	907015-N4	Adaptor	1	BRASS	No
11	907015-02S	Spout	1	Stainless Steel	No
12	SH22×1-M15×1-150 0S	Shower Hose	1	Stainless Steel+BRASS+ EPDM	Yes
13	A14-01X	Washer	2	EPDM+Stainless Steel	Yes
14	A03-J	Flow straightener	1	POM	Yes
15	907015-N1	Aerator Shell	1	BRASS	Yes
16	907016-N	Flange	1	ZINC	Yes
17	OR111	O ring	1	EPDM	Yes
18	N297-B	Fixing kit	1	Steel+NBR+Brass	Yes
19	N297-B06	Washer	1	ABS	Yes
20	907015-N	Aggravation Piece	1	STEEL+PP+ Stainless Steel	Yes
21	BZG10-1/2"-350-03	Braided Connectors	1	Stainless Steel+BRASS+ EPDM	Yes

Flow Rates

FAQ

What should I do if my tap is dripping/leaking?

Cleaning the valve (if water dripping from tap)

Before carrying out any maintenance, turn off the mains water supply.

1. Unscrew the lever, loosen the grub screw.
2. Remove the handle and spindle.
3. Remove the valve using a suitable spanner, clean thoroughly under cold water to
4. remove any build up of limescale or debris.
5. If necessary replace the valve.
6. Replace the valve into the body, tighten the valve using a suitable spanner.
7. Replace the handle and spindle, tighten the grub screw and re-fit lever to handle .

What does the Guarantee Cover?

The Guarantee Covering leakage, manufacturing defects and Chrome plating

The guarantee does not cover:

- Damage or defects caused by:
 - general wear and tear (including special non-chrome finishes; components such as filters, seals, 'O'rings and washers)
 - incorrect installation
 - repair using non- PPI parts
 - accidental or wilful misuse
 - corrosion and the use of inappropriate cleaning products.
 - system debris including the build up of limescale (which can be controlled through regular servicing and maintenance).
- Compensation for loss of use of the product or consequential loss of any kind.