

Waterforms

Single lever shower mixer for exposed installation

Finish: **Chrome** Article Number: **31956000**



Description

product features

- 1 function
- centre distance: 150 ± 12 mm
- maximum flow rate at 3 bar: 15 l/min
- flow rate of hand shower at 3 bar: 15 l/min
- ceramic cartridge
- temperature limitation adjustable
- non-return valve
- with silencer
- suitable for continuous flow water heaters
- hose connection DN15
- connection dimension: DN15
- min. operating pressure: 1 bar
- max. operating pressure: 10 bar
- connection type: s-shaped connections
- WRAS 2210047
- WRAS 2210047 - Approval letter 2210047

Article Details

Price excl. VAT

120,83 £

Product image

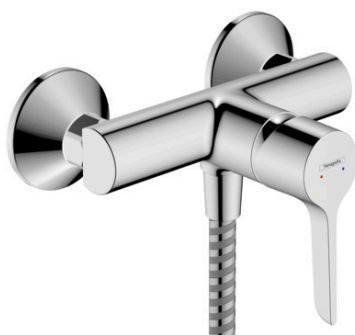

Scale drawing

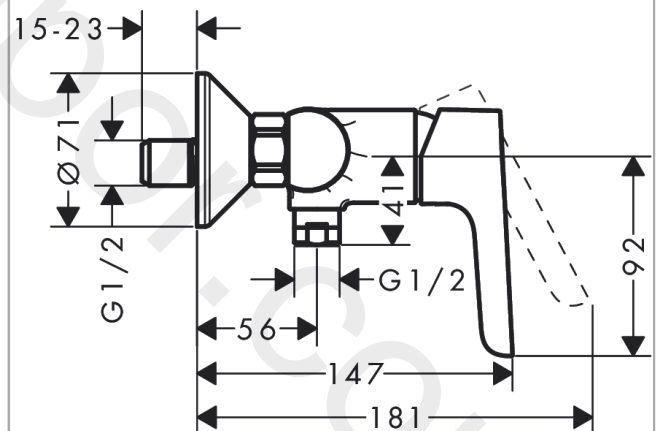

Waterforms

Single lever shower mixer for exposed installation

Finish: **Chrome** Article Number: **31956000**



Flowchart

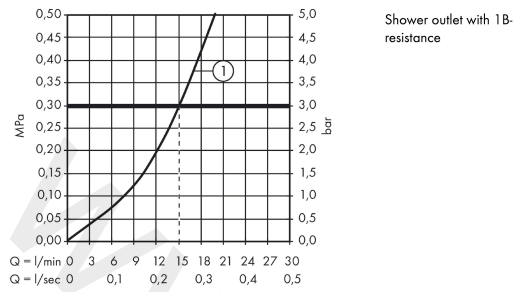

www.divapor.com

Waterforms

Single lever shower mixer for exposed installation

Finish: **Chrome** Article Number: **31956000**



Exploded Drawing

Year of production: >03/22

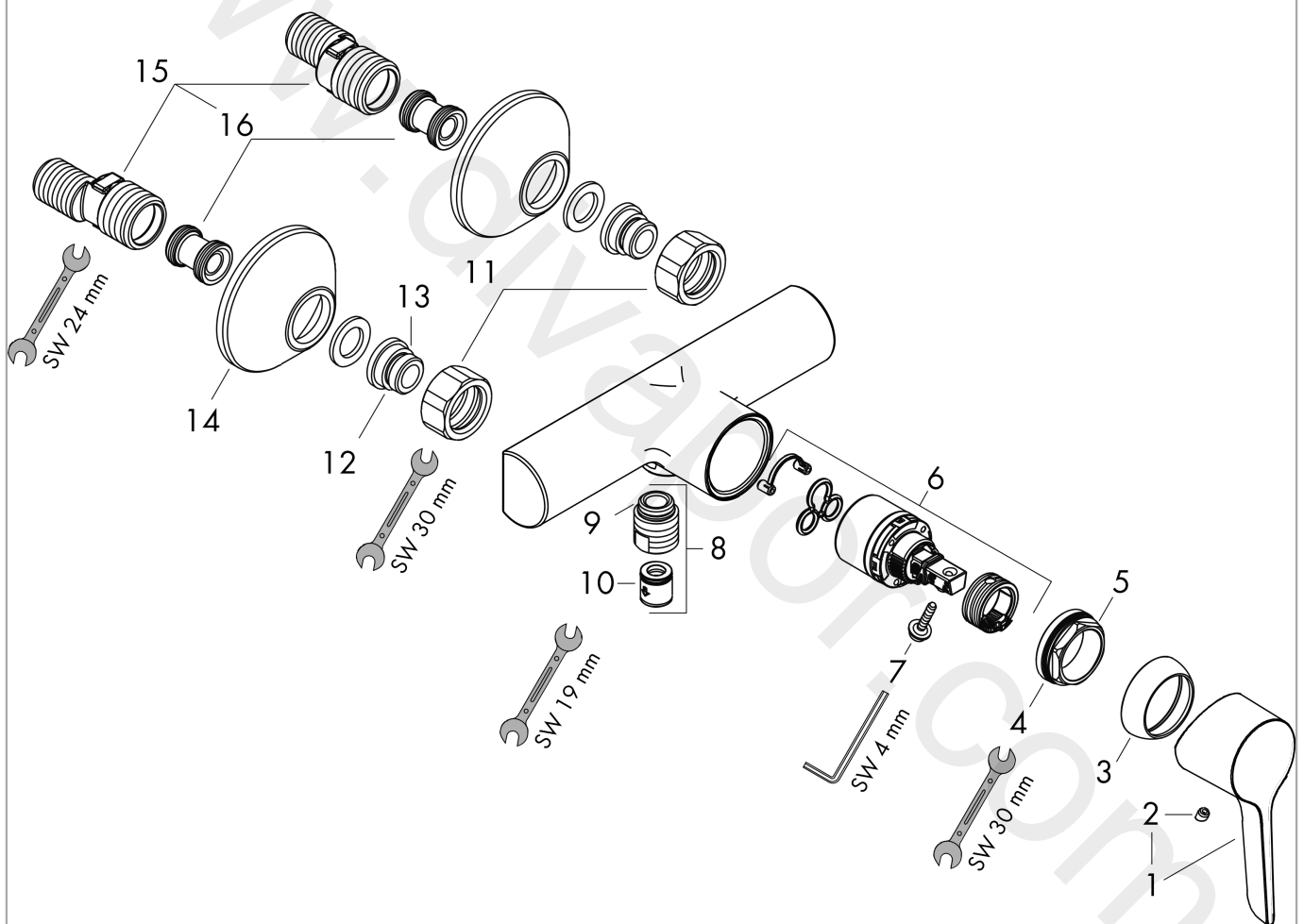

Waterforms**Single lever shower mixer for exposed installation**Finish: **Chrome** Article Number: **31956000****Spare part list**

Year of production: >03/22

Pos.	Description	Article Number	Price	PU
1	-	94638000	£ 51,00	1
2	screw cover	96338000	£ 3,30	1
3	flange	97406000	£ 20,50	1
4	nut	97209000	£ 16,10	1
5	O-Ring 32x2	98193000	£ 3,30	1
6	cartridge, assy	92730000	£ 35,00	1
7	locking screw for handle	95140000	£ 6,10	1
8	Hose Connection	96044000	£ 25,00	1
9	O-ring 14x2	98129000	£ 3,30	1
10	set of non return valves DW 15	94074000	£ 16,10	1
11	set of nuts	96157000	£ 35,00	1
12	connecting thread	97220000	£ 16,10	1
13	O-ring 15x2	98163000	£ 3,30	1
14	escutcheon Ø 70 mm	94135000	£ 13,30	1
15	set of S-unions (±12 mm)	94140000	£ 51,00	1
16	noise reduction	96429000	£ 6,10	1