



Vector bath/shower mixer and kit

nabis

Product code – A05428

With a striking cubic design, the nabis Vector range is a bold contemporary statement.



Features:

- 1/4 turn 3/4" head valve
- Chrome finish
- Brass tap body
- Zinc handle
- Neopearl aerator
- Minimum working pressure: 0.3 bar
- Operation pressure range: 0.3 bar – 5 bar
- Suitable for both low & high pressure systems

Flow rates				
Pressure (Bar)	Hot water only (L/m)	Cold water only (L/m)	Mix (L/m)	Shower (L/m)
0.1	3.80	3.90	4.20	1.80
0.2	4.80	4.90	5.30	2.50
0.3	6.20	6.30	6.30	3.00
0.4	9.60	9.60	9.50	4.00
0.5	12.80	12.80	14.50	5.20
1	22.00	22.00	27.50	9.50
2	32.50	32.50	40.00	15.00
3	40.00	40.00	–	19.50
4	–	–	–	24.00
5	–	–	–	27.00

Product dimension and weight	
Product dimension (mm)	230 x 142.5 x 181
Net weight (kg)	2.050
Gross weight (kg)	2.770



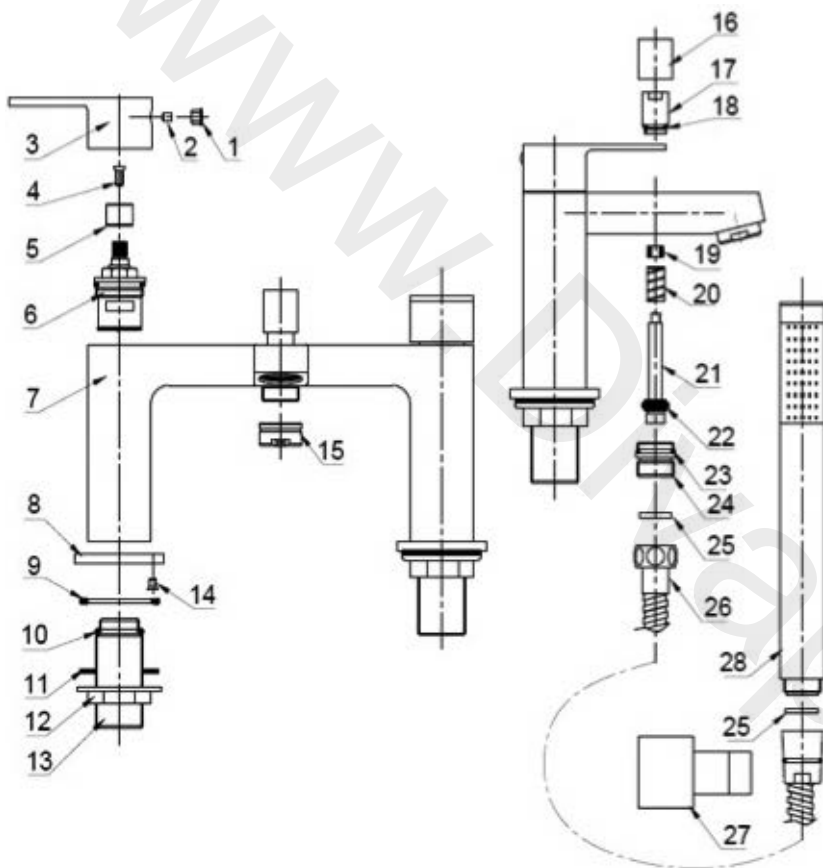

Details

Item	Description	Qty	Material	Spec
1	Indice	2	Plastic	-
2	Screw	2	Stainless Steel	M5X5
3	Handle	2	Zinc	-
4	Screw	2	Stainless Steel	M4X5
5	Nut	2	Plastic	-
6	Head Valve	2	Assembly	-
7	Body	1	Hpb59-1	-
8	Base Ring	2	Zinc	-
9	'O' Ring	2	Rubber	-
10	'O' Ring	2	Rubber	Ø18X2
11	'O' Ring	2	Rubber	-
12	Back Nut	2	Plastic	-
13	Inlet	2	Hpb59-1	G3/4
14	Screw	4	Stainless Steel	M4X5

Item	Description	Qty	Material	Spec
15	Aerator	1	Assembly	-
16	Head of Diverter	1	Hpb59-1	-
17	Cover	1	Hpb59-1	-
18	'O' Ring	1	Rubber	Ø11X1.8
19	'O' Ring	1	Rubber	-
20	Spring	1	Stainless Steel	-
21	Bar	1	Hpb59-1	-
22	'O' Ring	1	Rubber	-
23	'O' Ring	1	Rubber	Ø18X2.4
24	Connector	1	Hpb59-1	-
25	'O' Ring	2	Rubber	-
26	Shower Hose	1	Assembly	-
27	Bracket	1	Plastic	-
28	Hand Shower	1	Assembly	-

wolseley.co.uk

The information contained on this page was correct at date of issue. Fitting dimensions are provided as a guide only. Some variation may occur due to manufacturing tolerances. We pursue a policy of continuing improvement in design and performance of products and so reserve the right to change specifications without prior notice.

Version number 1.0



wolseley.co.uk