

nabis
fits perfectly



Care & Maintenance

To maintain the surface finishes, simply wipe occasionally with a mild detergent on a soft damp cloth. Dry using a soft cloth, never use abrasive cleaners or chemical household cleaners, and avoid contact with concentrated bleach.

Nabis products are manufactured to the highest of standards and should require little or no maintenance. In the unlikely event of any spare part requirements, please contact our free phone helpline number.

Free Phone Helpline

Should you require any technical help in association with your Nabis products please call 0344 292 7062 with your query.

Warranty: 5 Years

For detail warranty information, please visit our website: wolseley.co.uk

Address:

Plumb & Parts
Wolseley Center
Harrison Way
Leamington Spa
CV313HH

Website:

wolseley.co.uk



wolseley.co.uk

Instruction & Warranty Leaflet

Tap Instruction for Genius II Range

Water Regulations Requirements

It is important to ensure that the water supplies to your taps and mixers are connected in accordance with the water regulations (WRAS) requirements and good plumbing practice.

It is Wolseley's recommendation and good plumbing practice that the supplies of hot and cold water to the products should be equal (balanced) pressures in order to provide a consistent flow. Supplies should be from a common source. Either mains or tank fed. If supplies are not equal pressures then non return valves should be fitted (not supplied). These products have been designed to function on all types of water systems. Please note: if a pump is to be installed to boost gravity supplies please refer to the pump manufacturers instructions.

The hot and cold inlets for any of the products are hot on the left and cold on the right when viewed from the front of the fitting. It is our recommendation and good plumbing practice that a service valve also should be installed up stream in the inlet supply lines.

Pipe Connections

IMPORTANT. Before making any inlet pipe connections all supplies **MUST** be thoroughly flushed to remove any debris. Failure to do so could result in damage or low flow from the fitting.

It is a requirement of Byelaw 55 of the Water Fittings Byelaw Scheme that this function is undertaken before making

any pipe connections to supplies. It is a requirement of Byelaw 55 of the Water Fittings Byelaw Scheme that this function is undertaken before making any pipe connections to supplies

General Installation Notes

- Care must be taken during installation to prevent any risk of damage to the product or injury to installer
- Installation must be carried out by a qualified and competent person and in accordance with the instructions supplied.
- Installations must comply with all Local and National Water Authority Regulations and Building/Plumbing Regulations.
- Ensure that you have read and understood all sections of this manual before installation.

Water Supply Pressures

All fittings have been designed to function under the following conditions:

- Minimum supply pressure 0.1 bar
 - Maximum supply pressure 6.0 bar
- Generous flow rates are achieved at pressures as low as 0.1 bar. At high pressures it may be necessary to reduce excessive flow rates by fitting stop or servicing valves in the supply line before the mixer or tap. These stop valves facilitate ease of maintenance should it be necessary.

Installation

Basin and bath pillar taps:

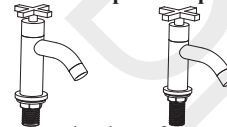

- Remove backnut from tap tails
- Fit tap through holes in ware ensuring anti-rotational washer is trapped in position between tap base and ware.
- Replace backnut and tighten.
- Thoroughly flush pipework. Hot should be on the left and cold on the right when viewing pipework from the front.

Monobloc and mini monobloc basin:

Nabis Basin mixers are supplied with separate inlet tails flexible tails.

- Screw inlet tails into body and tighten up ensuring "O" ring seal is firmly in place and leak proof.
- Securing stud to be fitted and tightened
- Locate seal under flange (or base of monobloc)
- Place fitting through hole in ware
- Place washer cover inlet tails and position on underside of ware
- Place clamping plate on the threaded stud ensuring that stud is positioned in the slot in the clamping plate and the inlet tails are positioned in the cut out.
- Place fixing nut onto threaded studs and loosely tighten
- Position brassware or worktop and firmly tighten the fixing nut

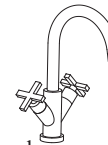

- Thoroughly flush pipework. Hot should be on the left and cold on the right when viewing pipework from the front.

Bath filler and bath shower mixer:

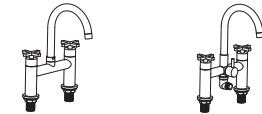

- Remove backnuts from tap tails
- Fit tap through holes in ware ensuring anti-rotational washer is trapped in position between tap base and ware.
- Replace and tighten backnuts from beneath bath.
- Thoroughly flush pipework. Hot should be on the left and cold on the right when viewing pipework from the front.
- Connect Pipework to tap and check for leaks.
- Fit shower hose and kit to the bath mixer.

Fixing the shower kit

- Mark the holes and drill
- Insert suitable raw plugs
- Fasten the brackets with screw
- Click on the shell and connect the shower hose