



Roca

ATLAS

A5A3090C0R

A5A3290C0R









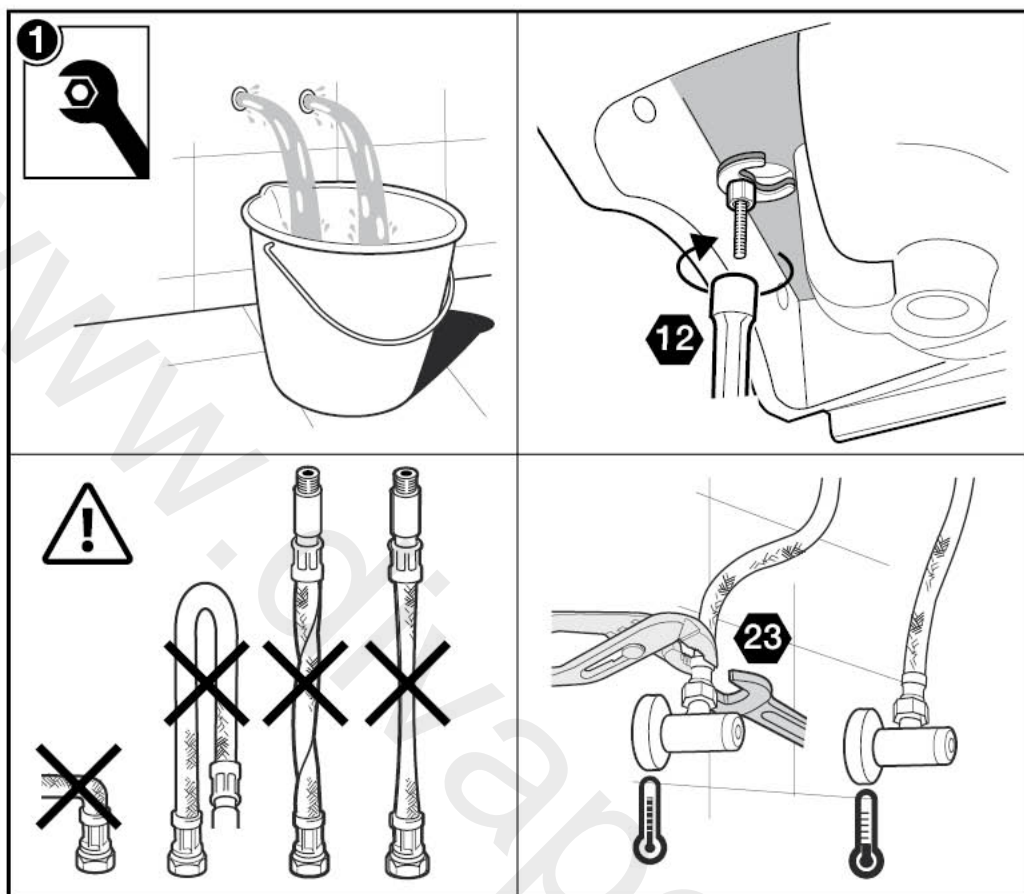





A5A3D90C0R

A5A3990C0R

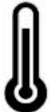
A5A3790C0R





 P 	P bar	 MAX 10	
 P 	P bar	MIN 0,1  5 MAX	 3 1 
  T	°C	 80 MAX.	 65 50 
 Q (3 bar)	l/min		 5



A5A3090C0R

A5A3290C0R

A5A3990C0R

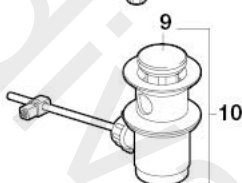
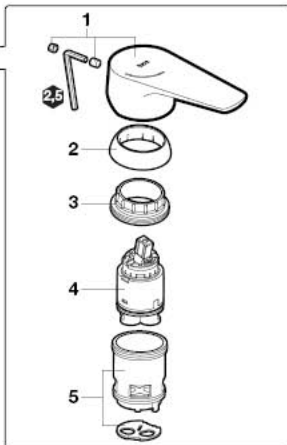
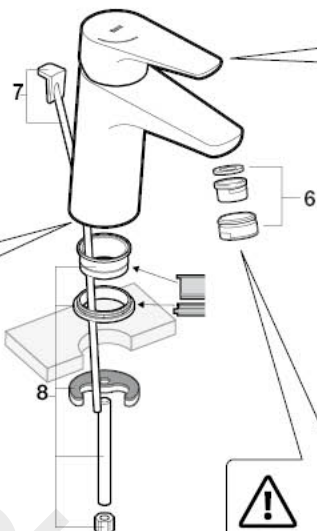

A5A3D90C0R

A5A3790C0R

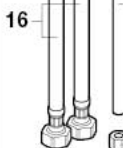
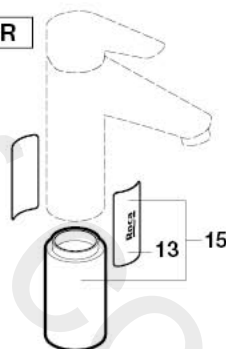
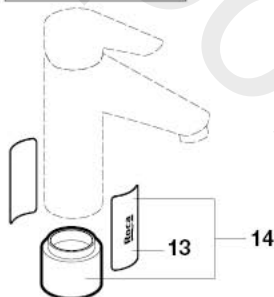

1 - AG0116100R

2 - AG0085300R

3 - A525023507

4 - AG0141207R

5 - AG0096307R

6 - AG0046600R (>0.5 bar)

6 - A525005800 (<0.5 bar)

7 - A525020600

8 - A525004403

9 - AG0096200R

10 - AG0075300R

11 - AG0126009R

12 - A525030303

13 - AG0117207R

14 - AG0117100R

15 - AG0117400R

16 - AG0125909R

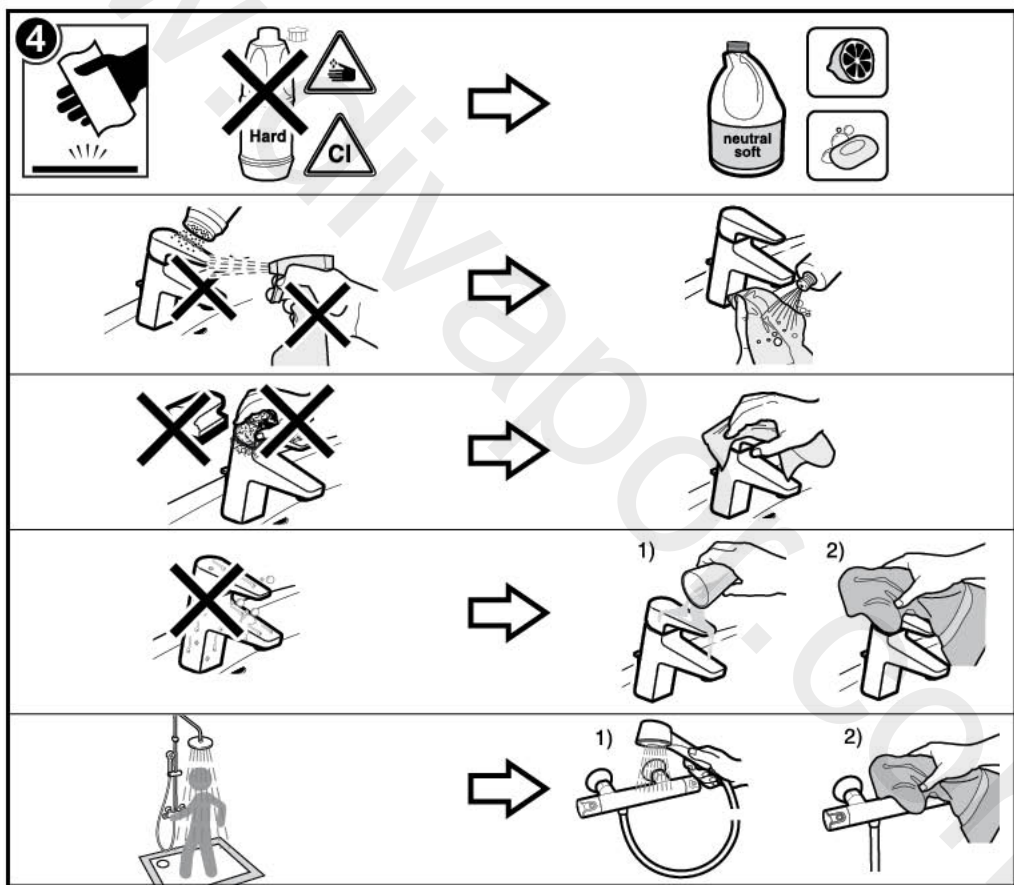
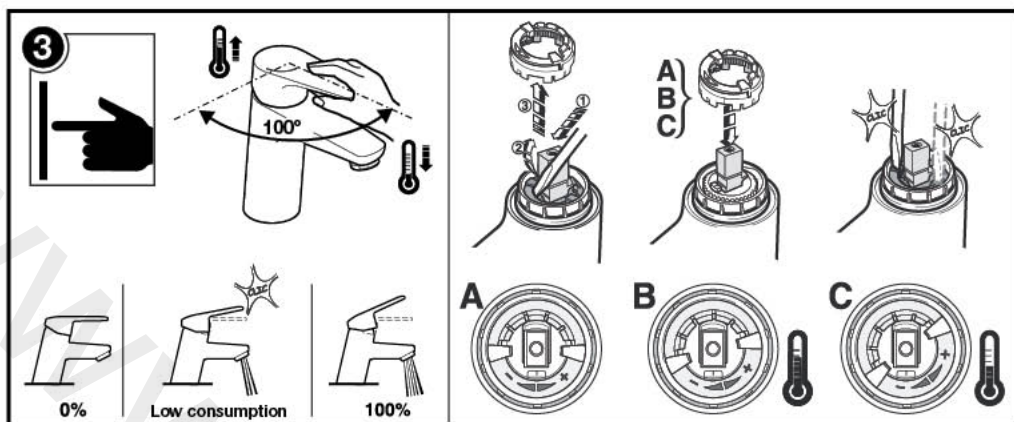

A523099807e

Roca

Roca Ltd
 Samson Road
 Hermitage Industrial Estate
 Coalville
 Leics LE65 3FP
 UK
 Tel number : 01530 830080
 www.uk.roca.com

 productsupport.rs@roca.net
 soporteproducto.rs@roca.net