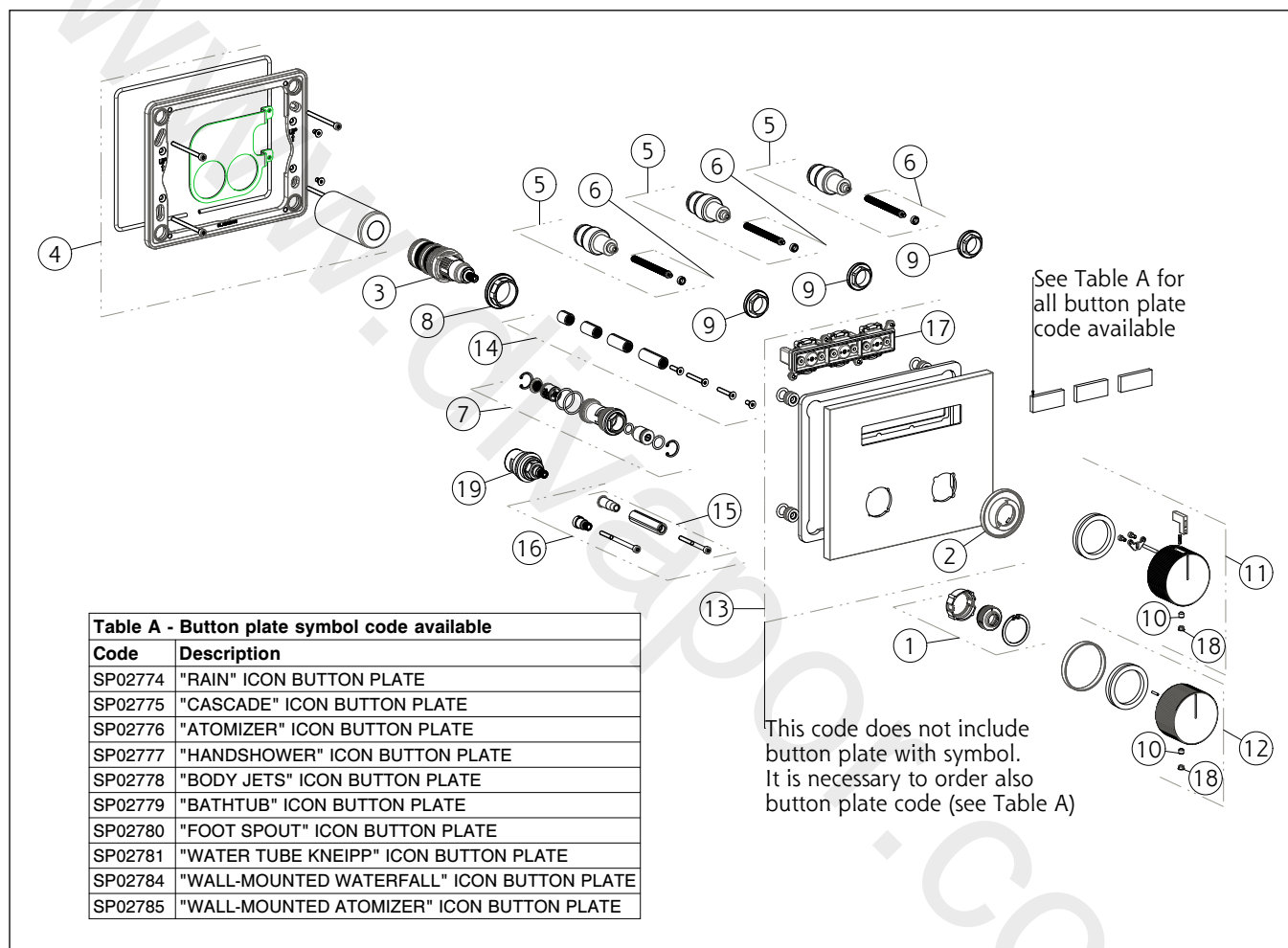

**GISSI**<sup>®</sup>**63006**

GPF630060G001G000

**COMPACT**data di validità/validity date  
≥ 7/2020

Parti esterne per miscelatore termostatico a tre funzioni indipendenti, con pulsanti on-off.  
External parts for thermostatic mixer for three separate functions, with push-button on/off controls.

**Table A - Button plate symbol code available**

Code	Description
SP02774	"RAIN" ICON BUTTON PLATE
SP02775	"CASCADE" ICON BUTTON PLATE
SP02776	"ATOMIZER" ICON BUTTON PLATE
SP02777	"HANDSHOWER" ICON BUTTON PLATE
SP02778	"BODY JETS" ICON BUTTON PLATE
SP02779	"BATHTUB" ICON BUTTON PLATE
SP02780	"FOOT SPOUT" ICON BUTTON PLATE
SP02781	"WATER TUBE KNEIPP" ICON BUTTON PLATE
SP02784	"WALL-MOUNTED WATERFALL" ICON BUTTON PLATE
SP02785	"WALL-MOUNTED ATOMIZER" ICON BUTTON PLATE

N°	Code	Descrizione	Description
1	SP02849	ANELLO	RING
2	SP02846	ANELLO INDICATORE	INDICATOR RING
3	SP01936	CARTUCCIA TERMOSTATICA	THERMOSTATIC CARTRIDGE
4	SP02848	CONTROPIASTRA	SUB PLATE
5	SP02844	DEVIATORE A PULSANTE	PUSH-BUTTON DIVERTER
6	SP03364	DISTANZIALE	SPACER
7	SP01942	FILTRO	FILTER
8	SP01937	GHIERA SERRAGGIO CARTUCCIA	FIXING RING NUT
9	SP02845	GHIERA SERRAGGIO CARTUCCIA	FIXING RING NUT
10	SP00610	GRANO	SCREW
11	SP02841	MANIGLIA	HANDLE

N°	Code	Descrizione	Description
12	SP02842	MANIGLIA	HANDLE
13	SP02863	PIASTRA IN FINITURA	FINISHING PLATE
14	SP01931	PROLUNGA	EXTENSION
15	SP01933	PROLUNGA	EXTENSION
16	SP02851	PROLUNGA	EXTENSION
17	SP02862	PULSANTE	PUSH BUTTON
18	SP00002	TAPPINO COPRI GRANO	SCREW COVER
19	SP02843	VITONE	HEADVALVE