

# SHOWER AND BATH/SHOWER THERMOSTATIC MIXER

## **Technical data.**

Hydraulic pressure: Min.0.5bar/Max.10.0bars

Service pressure for the automatic inverter Shower/Tub spout: Min.0.5bar/Max.5.0bars

Suggested service pressure: Min.1.0bar/ Max.5bars. (For pressure above 5.0 bar a pressure reducer should be installed)

Pressure control: 6.0bars (air)

Maximum suggested hot water temperature: 80°C

Suggested temperature (water heater): 60°C

It is advisable to avoid important and sudden variations in between hot and cold water. To be able to adjust the water temperature higher then 38°C. It is necessary to press on the safety chrome-plate button prior to turning the temperature control handle.

## **Mounting Instructions**

The provided eccentric connections allows the installation on wall water supplies with Adjustment distance set in between 132 and 168mm

Prior to the installation make sure that no fragments or deposit are blocking the inner pipes and respect the water supply connection (cold water to the right and warm water to the left).

Warning: when the installation is correct, the temperature control handle has to be on the right-hand side and the shower flexible hose connection downward.

Screw the eccentric connections to the water supplies having beforehand applied a Teflon band to the threading.

Adjust the eccentric connections so that the mixer is in horizontal position and set between both connections.

Screw both conical plates on the eccentric connections.

Do not forget both fiber gaskets, install the mixer and screw the nuts by tightening them with an end wrench

## **Cartridge replacement or cleaning**

**NOTE: Only a qualified/competent person should undertake this procedure**

1. "Remove the plastic end cap to reveal the screw that removes the control head, unscrew and remove the head.

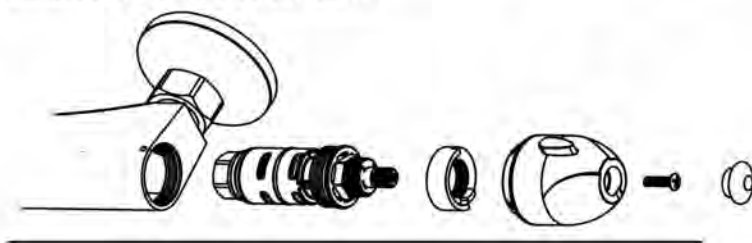

2. Remove the plastic flow stop and rotate it a quarter of a turn anti-clockwise then refit.

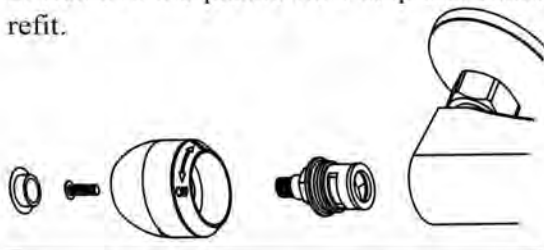

3. Test for correct temperature but be careful of the hot temperature.  
Repeat procedure until correct temperature is reached.  
Replace all parts.