

inta

Infra Red Basin Tap

IR180CP.1 Battery Operated

Installation and Maintenance Instructions



inta

Intatec Ltd

Airfield Industrial Estate
Hixon
Staffordshire
ST18 0PF

In this procedure document we have endeavoured to make the information as accurate as possible.

We cannot accept any responsibility should it be found that in any respect the information is inaccurate or incomplete or becomes so as a result of further developments or otherwise.

Tel: **01889 272 180**

Fax: **01889 272 181**

email: **sales@intatec.co.uk**

web: **www.intatec.co.uk**

Introduction

These instructions cover the installation, operation and maintenance of the IR180CP infra red tap. Please read the enclosed instructions before commencing the installation of this product, please note;

We recommend that the installation of any Inta product is carried out by an approved installer.

The installation must be carried out strictly in accordance with the Water Supply (Water Fitting) Regulations 1999 and any local authority regulations.

If in doubt we recommend that you contact WRAS - Water Regulations Advisory Scheme on Tel: 0333 207 9030, your local water authority - details available on the WRAS website or the Chartered Institute of Plumbing and Heating Engineers on Tel: 01708 472 791.

Products

Infra Red Basin Tap

IR180CP.1

Check Content

Before commencing remove all components from packaging and check each component with the contents list.

Ensure all parts are present, before discarding any packaging. If any parts are missing, do not attempt to install your Inta shower valve until the missing parts have been obtained.

Technical Data

Operating water pressure range:

1 to 8 bar (recommended max 5 bar)

With water pressure in excess of 8 bar use with a pressure reducing valve

Water temperature operating range:

5 to 65 °C

Power supply:

6V lithium battery mod. CRP-2 or
230V AC main powered / 6V DC
w/safety device anti black-out.

Operating

Putting your hands under the aerator and in front of the sensor starts the water flow.

The tap shuts off when hands are removed or after one minute of water flow.

The mixed water temperature can be increased or reduced by adjusting the lever on the side of the tap.

Dimensions

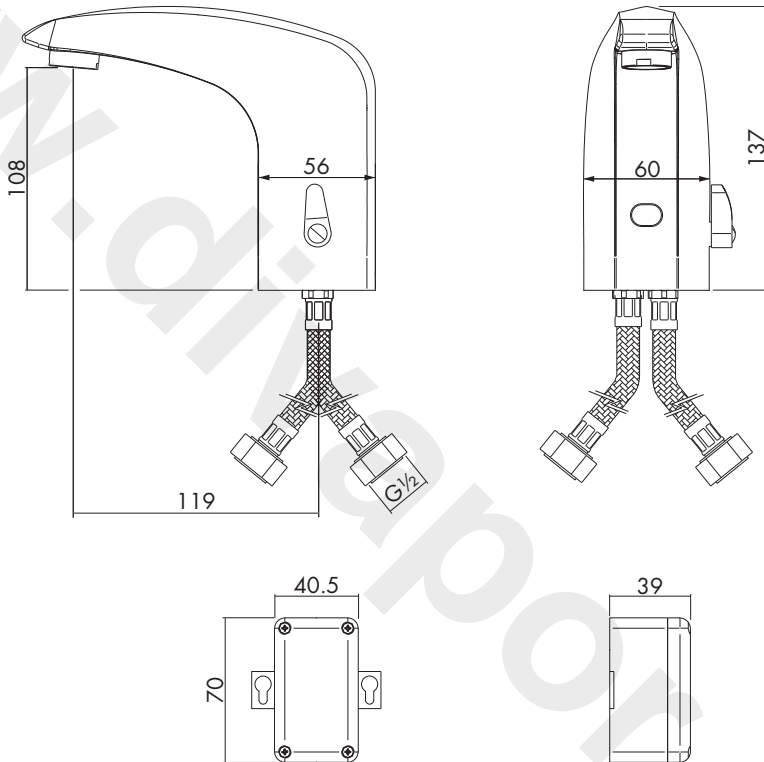

Components

Item Qty Component

| | | |
|---|---|----------------------------|
| 1 | 1 | Tap |
| 2 | 1 | Fixing kit |
| 3 | 1 | Battery box |
| 4 | 2 | Wall plug and fixing screw |

Item Qty Component

| | | |
|---|---|-------------------------------|
| 5 | 2 | Stainless steel flexible hose |
| 6 | 2 | Inlet nut |
| 7 | 2 | Sealing washer |
| 8 | 1 | Power cable |

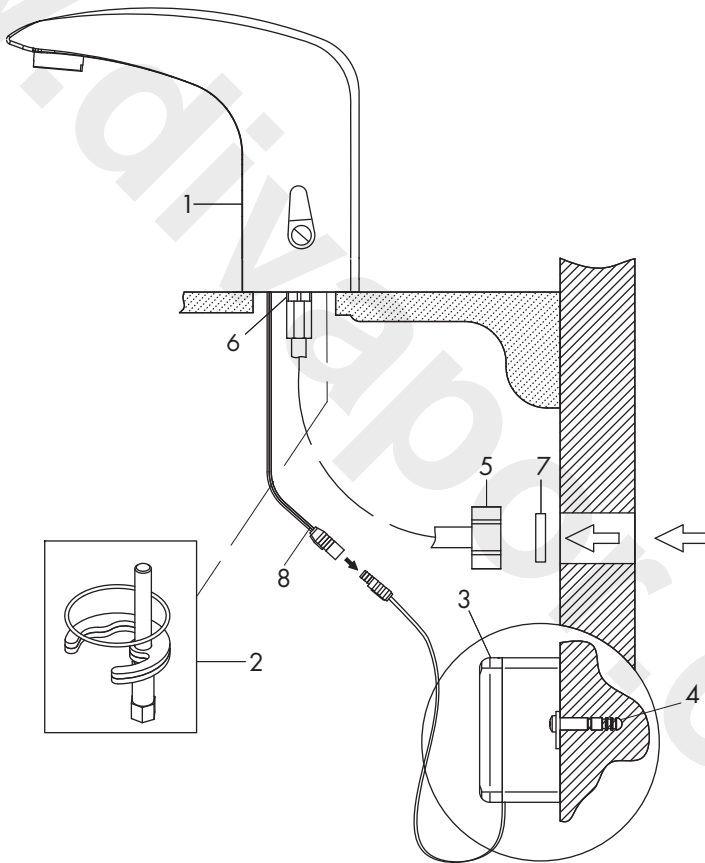

Pre-installation Information

Warning

- Do not install the tap facing a mirror or any other electronic system operated by an infra red sensor.
- To prevent reflection problems, it is recommended to keep a minimum distance of 1.5m between the tap and other objects.
- Do not expose the tap to temperatures lower than 5°C (for example during winter time): otherwise arrange for the system to be drained.
- Adequate provision must be made to ensure the water quality (including limescale); the presence of debris may damage the solenoid valve.
- For pre-mixed water a thermostatic mixing valve with integral isolating valves should be installed in the supply pipe to the HOT connection of the tap.
- We recommend that a service valve and check valve are installed in the supply pipe to the COLD connection of the tap should maintenance be required in the future.

Preparation for installation

Flush the water supply pipes thoroughly prior to installation. Do not allow debris, PTFE tape or any metal particles to enter the tap.

Turn off the water supply.

Important - All plumbing to be installed in accordance with applicable codes and regulations.

Installation

FAILURE TO OBSERVE THE INSTALLATION INSTRUCTIONS WILL INVALIDATE THE PRODUCT WARRANTY CONDITION.

- 1 Screw the flexible hoses (5) into the inlet nuts (6) and the threaded rod from the fixing kit into the base of the tap.
- 2 Locate the 'O' ring from the fixing kit into recess in the base of the tap.
- 3 Position the tap (1) into the hole in the basin and secure using the horse shoe washer and retaining nut from the fixing kit (2).
- 4 Connect the flexible hoses (5) to the water supplies using the ½" sealing washers (7) and make water tight joints.

ATTENTION: failure to fit filters on the supply pipes can damage the solenoid valve and automatically invalidate the product warranty.

- 5 Fix the power supply unit (3) using the screws (4), ensuring the power cable exits from the bottom as shown.

ATTENTION: Do not connect the power supply until it required.

Activating

- 1 Check that the sensor windows is cleaned and remove any potential objects.
- 2 Open the isolation valves on the water supplies.
- 3 Fit the batteries inside the box/power supply unit, connect cable from the power supply unit (3) to the cable (8) from the tap.
- 4 The LED in the sensor window flashes: when it stops flashing the taps is ready for use.

Setting the Detecting Distance

The detecting distance of the sensor is set at 12 cm but can be reset by the user from a minimum of 5cm to a maximum of 25 cm (approximately).

- 1 Remove the battery from the box or turn off the power at the socket.
- 2 Wait 30 seconds and reconnect the power supply.
- 3 When the red LED flashes (if it switches off, it is necessary to remove the battery from the box and repeat the operation), put one hand immediately in front of the sensor (at a distance of max. 5cm.
- 4 When the red LED lights up permanently, move your hand to the desired distance.
- 5 Wait for the LED to switching off before removing your hand, at this point the new distance is recorded. This new setting will be stored in case of battery replacement (or lacking of electricity).

Safety Device

To prevent flooding of the premises following an act of vandalism or misuse (an object left in front of the sensor or a dirty sensor), the tap has a safety device that shuts off the water flow after about one minute.

Once the object has been removed (or the sensor has been cleaned), the tap starts working again. Taps with a power supply unit have an anti black-out function which ensures the water flow stop if the electricity supply fails and prevent it starting again until the electricity supply has been restored.

Maintenance

Cleaning

In order to keep the tap operating efficiently and maintain its appearance it is necessary to periodically carry out a number of simple maintenance operations including:

The high quality chrome finish and the darkened plastic window which protects the sensor, must be kept clean to maintain correct operation, both surfaces should be treated with care.

An occasional wipe with a mild washing-up liquid on a soft damp cloth followed by a thorough rinse and wipe dry with a soft clean cloth is all that is required.

Do not use an abrasive or chemical household cleaner as this may cause damage to the surface.

Maintenance

Cleaning

ATTENTION: Turn of the water supply at the ball valve before removing the filter.

Some supplies can contain particles and impurities which could damage the solenoid valve.

As part of package, a water supply filter is included which must be kept clean to ensure maximum water flow.

Clean the filter by washing thoroughly using running water.

Battery Replacement

When the battery is exhausted, the LED flashes continuously and the solenoid valve stops in the closed position.

Remove the exhausted battery and repeat the operations described in the section “Activating” in order to re-store the operation of the tap.

Trouble Shooting

The following details are supplied for on site queries, should further assistance be required our Technical Department can be contacted directly on 01889 272199

| Fault | Cause | Solution |
|---|---|---|
| No water flow | The isolation valves are closed | Open the isolation valves |
| | Exhausted battery (LED flashes) | Replace the battery |
| | Electrical problem | Check the voltage Disconnect and reconnect the battery (where applicable) Check the connections and the cable's integrity Damaged sensor: ask for assistance |
| | Dirty sensor | Clean the sensor window |
| | Filters are dirty | Close the isolation valves and clean the filters |
| | Blocked solenoid valve | Ask for assistance |
| The water flows for 1 minute (without any object in front of the sensor), finally stops | Dirty Sensor | Clean the sensor window |
| | Light reflection on the sensor | Remove the reflective surface |
| | Electronic problem | Disconnect and reconnect the battery |
| The water flows for more than 1 minute | Blocked solenoid valve / damaged sensor | Ask for assistance |

Warranty

Limited Warranty

This product is covered by a limited warranty for one year from the date of purchase.

During this period Intatec Ltd undertakes, at its option, to repair or replace any faults caused by defective material or manufacturing that may arise (see Intatec Warranty).

The warranty does not cover damage caused by;

Abnormal or improper use.

Incorrect installation or water system problems.

Normal wear or negligence in maintenance and in use.

Acts of vandalism

Contact with abrasives, corrosive chemicals or unsuitable cleaning agents or instruments.

Please leave this Manual for the User

To activate your product warranty please visit

www.intatec.co.uk

and click on Product Registration

inta

Intatec Ltd

Airfield Industrial Estate

Hixon

Staffordshire

ST18 0PF

Tel: **01889 272 180**

Fax: **01889 272 181**

email: **sales@intatec.co.uk**

web: **www.intatec.co.uk**