

WAI00

DOLPHIN PRESTIGE COUNTER MOUNTED BASIN TAP

INSTALLATION AND MAINTENANCE GUIDE



October 2020

D
DOLPHIN
PRESTIGE

DOLPHIN WAI00 INSTRUCTIONS

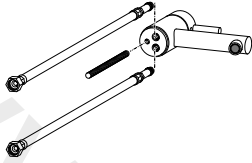

1. Screw the two flexible connectors into the holes provided. Screw the threaded rod in the hole provided in the body of the tap.

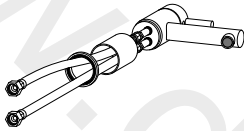

2. Pull the shaft and the base ring over the tubing and threaded rod for fitting.

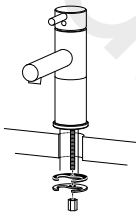

3. Locate the tap into the hole provided in the sink/countertop. From the underside slide the crescent gasket and the metal disk onto the threaded rod, tighten the fitting using the brass-coloured locking nut.

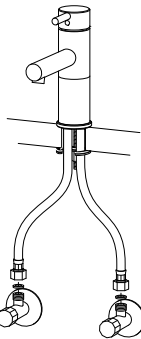

4. Connect the two flexible hoses with the cold and the hot water inlets to the relevant water supply. For a seal there must always be a washer in the floating nut on the end of the flexible connectors.

5. Check all connections for leakage.



Dolphin Solutions Ltd
Southpoint, Compass Park, Bodiam,
Robertsbridge, TN32 5BS

Tel: +44 (0)1424 20 22 24
Fax: +44 (0)1424 205 200
info@dolphinsolutions.co.uk
www.dolphinsolutions.co.uk